



Project:	Type:
Prepared By:	Date:

Driver Info		LED Info	
Type	Constant Current	Watts	94.00W
120V	N/A	Color Temp	4000K (Neutral)
208V	N/A	Color Accuracy	72 CRI
240V	N/A	L70 Lifespan	100,000
277V	N/A	Lumens	10,961
Input Watts	95.30W	Efficacy	115 LPW
Efficiency	99%		

Technical Specifications

<p>Listings</p> <p>UL Listed: Suitable for wet locations</p> <p>IESNA LM-79 & IESNA LM-80 Testing: RAB LED luminaires have been tested by an independent laboratory in accordance with IESNA LM-79 and LM-80</p> <p>Title 24 Compliant: An IVELOT edge-lit area light can be used with a motion sensor or photocell control option to comply with 2016 Title 24 Part 6 Section 130.2 (a,b,v)</p> <p>DLC Listed: This product is on the Design Lights Consortium (DLC) Qualified Products List and is eligible for rebates from DLC Member Utilities. DLC Product Code: PB7NRK6T</p> <p>LED Characteristics</p> <p>Lifespan: 100,000-hour LED lifespan based on IES LM-80 results and TM-21 calculations at 25°C</p> <p>LEDs: Long-life, high-efficacy, surface-mount LEDs</p> <p>Color Stability: LED color temperature is warranted to shift no more than 200K in CCT over a 5-year period</p>	<p>Color Uniformity: RAB's range of CCT (Correlated Color Temperature) follows the guidelines of the American National Standard for Specifications for the Chromaticity of Solid State Lighting (SSL) Products, ANSI C78.377-2017.</p> <p>Construction</p> <p>IP Rating: Ingress Protection rating of IP66 for dust and water</p> <p>Cold Weather Starting: Minimum starting temperature is -40°C (-40°F)</p> <p>Maximum Ambient Temperature: Suitable for use in 40°C (104°F)</p> <p>Housing: Precision die-cast aluminum</p> <p>IES Classification: Type VS distributes light in a square symmetrical pattern and is meant for large, commercial parking lot lighting as well as areas where sufficient, evenly distributed light is necessary</p> <p>Mounting: 2 3/8" slipfitter mount with stainless steel hardware</p>	<p>Lens: Diffused Polymethyl Methacrylate (PMMA)</p> <p>Effective Projected Area: EPA = 0.61</p> <p>Finish: Formulated for high durability and long-lasting color</p> <p>Green Technology: Mercury and UV free. RoHS-compliant components.</p> <p>Other</p> <p>Warranty: RAB warrants that our LED products will be free from defects in materials and workmanship for a period of five (5) years from the date of delivery to the end user, including coverage of light output, color stability, driver performance and fixture finish. RAB's warranty is subject to all terms and conditions found at rablighting.com/warranty.</p>
--	---	---

Technical Specifications (continued)

Other

Buy American Act Compliance:

RAB values USA manufacturing! Upon request, RAB may be able to manufacture this product to be compliant with the Buy American Act (BAA). Please contact customer service to request a quote for the product to be made BAA compliant.

Electrical

Driver:

Class 2, 50/60Hz, 480V 4kV standard, 10kV optional

THD:

11.5% at 480V

Power Factor:

97.1% at 480V

Optical

BUG Rating:

B3 U0 G2

Dimensions

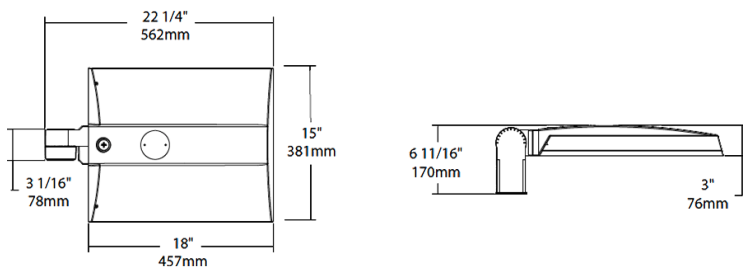

Features

- 0-10V Dimming, standard
- 100,000-Hour LED lifespan

Ordering Matrix

Family	Distribution	Lumen Output	Mounting	CRI/Color Temp	Finish	Voltage/Driver	Sensor Options	Lightcloud Option
IVA	T5S	100L	SF	740	W	H		
T2 = Type II T3 = Type III T4 = Type IV T5S = Type V Square FT = Forward Throw	45L = 4,500 lumens (38W) 75L = 7,500 lumens (67W) 100L = 10,000 lumens (94W) 130L = 13,000 lumens (117W)	PA = Universal Pole Adapter WM = Wall mount SF = Slipfitter	750 = 70CRI 5000K 740 = 70CRI 4000K 730 = 70CRI 3000K	Z = Bronze W = White G = Roadway Gray K = Black	U = 120-277V 0-10V Dimming H = 347-480V, 0-10V Dimming	Blank = No Options /WS = 8ft lens Wattstopper /WS2 = 20ft lens Wattstopper /WS4 = 40ft lens Wattstopper /7PR = 7-Pin receptacle	Blank = No Lightcloud® /LC = Lightcloud® Controller	