



Replace 200W and 250W MH lamps for wallpacks. Water/dust resistant. Uses 76% less energy than MH. 350° rotatable base puts light where you need it.

Color: White

Weight: 2.2 lbs

<b>Project:</b>	<b>Type:</b>
<b>Prepared By:</b>	<b>Date:</b>

Driver Info		LED Info	
Watts:	60W	Input Voltage:	100-277V
Color Temp:	5000K (Daylight)	Power Factor:	0.9
Lumens:	9,300	Flicker:	<30%
Efficacy:	155 LPW	THDi:	<20%
Color Accuracy:	80 CRI		
L70 Accuracy:	50,000		

## Technical Specifications

### Listings

**UL Listed:**

Yes

**UL Classified:**

Yes

**FCC:**

Yes

**Rohs:**

Yes

**CEC Status:**

Lawful for sale in California

**DLC Qualified:**

Yes

**DLC Listed:**

This product is on the Design Lights Consortium (DLC) Qualified Products List and is eligible for rebates from DLC Member Utilities.

DLC Product Code: PLFRALVVSM40

**Description**

**Lamp Type:**

HID

**Bulb Type:**

Wall Pack

**Base Type:**

EX39, Mogul Base

**Dimmable:**

No

**Construction**

**Operating Temperature:**

-20 - 40°C

**Bare Lamp Illuminated Length (inches):**

7.56"

**MOL (inches):**

10.67"

**MOD (inches):**

3.62"

**Minimum Compartment Size (inches):**

Length: 7.87"  
Width: 7.87"  
Height: 11.81"

### LED Characteristics

**Lifespan:**

50,000-hour LED lifespan based on IES LM-70 results

**Other**

**Equivalent:**

250W HID Wall Pack

**Warranty:**

5 years

**Optical**

**Beam Angle:**

180°

**Shipping Information**

**Case Qty:**

12

**Case Dimensions:**

16.73 x 12.68 x 12.6

**Pallet Quantity of Pieces:**

144

**Pallet Dimensions:**

27.32 x 35.43 x 42.52

# HID-60-H-EX39-850-BYP-WP

## Dimensions

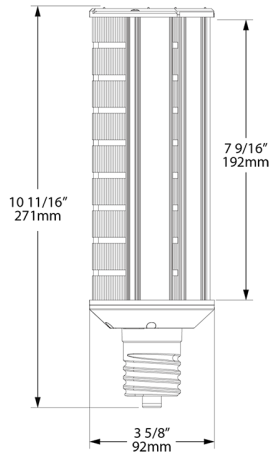

## Features

- Uses 76% less energy than traditional lamps
- Integral Driver, Eliminates the Need for External Driver or Ballast
- Includes 4kV Surge Protection
- 350 ° rotatable base, directs light where needed
- Integrated Heat Sink Quickly Dissipates Heat
- Suitable for Use in Fully Enclosed Fixture
- Water and dust resistant, ideal for outdoor use
- Environmentally friendly: No Mercury Used